

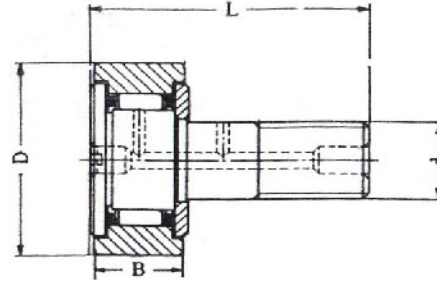

## Stud type track rollers

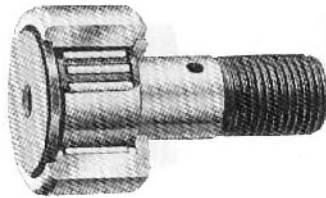

**Dimension table . Dimension in inch**

Number Cylindrical Outer ring	Crowned Outer ring	Weight (g)	Dimensions								Basic load rating		
			d1		D		Thread UNF	B		B1		Dyn.	Stat.
			inch	mm	inch	mm			inch	mm	inch	mm	(kgf)
CR 8	CR 8 UU	9	-	4.826	1/2'	12.700	NO.10-32	3/8'	9.525	7/8'	22.225	2 394	2 033
CR 8-1	CR 8-1 UU	10	-	4.826	1/2'	12.700	NO.10-32	13/32'	10.319	1.1/32'	26.194	2 394	2 033
CR 10	CR 10 UU	19	1/4'	6.350	5/8'	15.875	1/4'-28	7/16'	11.112	1.1/16'	26.988	3 467	3 486
CR 10-1	CR -1 UU	21	1/4'	6.350	5/8'	15.875	1/4'-28	15/32'	11.906	1.7/32'	30.956	3 467	3 486
CR 12	CR 12 UU	35	3/8'	9.525	3/4'	19.050	3/8'-24	17/32'	13.494	1.13/32'	35.719	4 199	4 854
CR 14	CR 14 UU	46	3/8'	9.525	7/8'	22.225	3/8'-24	17/32'	13.494	1.13/32'	35.719	4 550	5 519
CR 16	CR 16 UU	73	7/16'	11.112	1	25.400	7/16'-20	21/32'	16.669	1.21/32'	42.069	8 369	10 260
CR 18	CR 18 UU	88	7/16'	11.112	1.1/8'	28.575	7/16'-20	21/32'	16.669	1.21/32'	42.069	8 721	11 020
CR 20	CR 20 UU	132	1/2'	12.700	1.1/4'	31.750	1/2'-20	25/32'	19.844	2.1/32'	51.594	13 490	15 200
CR 22	CR 22 UU	157	1/2'	12.700	1.3/8'	34.925	1/2'-20	25/32'	19.844	2.1/32'	51.594	13 490	15 200
CR 24	CR 24 UU	225	5/8'	15.875	1.1/2'	38.100	5/8'-18	29/32'	23.019	2.13/32'	61.119	17 670	23 085
CR 26	CR 26 UU	260	5/8'	15.875	1.5/8'	41.275	5/8'-18	29/32'	23.019	2.13/32'	61.119	17 670	23 085
CR 28	CR 28 UU	365	3/4'	19.050	1.3/4'	44.450	3/4'-16	1.1/32'	26.194	2.25/32'	70.644	23 845	36 290
CR 30	CR 30 UU	410	3/4'	19.050	1.7/8'	47.625	3/4'-16	1.1/32'	26.194	2.25/32'	70.644	23 845	36 290
CR 32	CR 32 UU	615	7/8'	22.225	2	50.800	7/8'-14	1.9/32'	32.544	3.9/32'	83.344	30 875	60 705
CR 36	CR 36 UU	750	7/8'	22.225	2.1/4'	57.150	7/8'-14	1.9/32'	32.544	3.9/32'	83.44	30 875	60 705

- Models with a stud diameter d1 of 6.35 mm or less have no oil hole. Other models are provided with one oil hole each on the outside surface and end surface of the stud.
- Provided with prepacked grease.